



TOOLS NEEDED:



- Adjustable Wrench

STEP 1



WARNING

Turn the Sink OFF. Unplug the sink from the wall outlet before performing any of these steps.

STEP 2



Disconnect Fresh Water Tank.

STEP 3

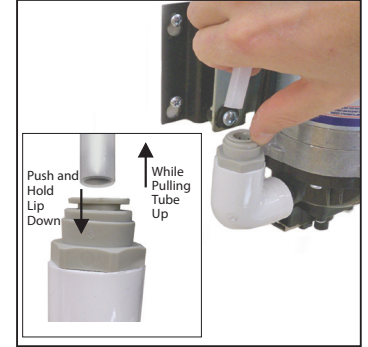

Disconnect the Quick Connect tube from the Pump Inlet (See A on Diagram 1)

STEP 4



Remove both electrical plugs from the Power Switch inside the cabinet.

STEP 5



Turn to loosen the top water line nut only. (See B on Diagram 1) Turn Counter-Clockwise.



STEP 6



Turn to loosen the left water line nut on the bottom of the Heater (See C on Diagram 1).

Diagram 1

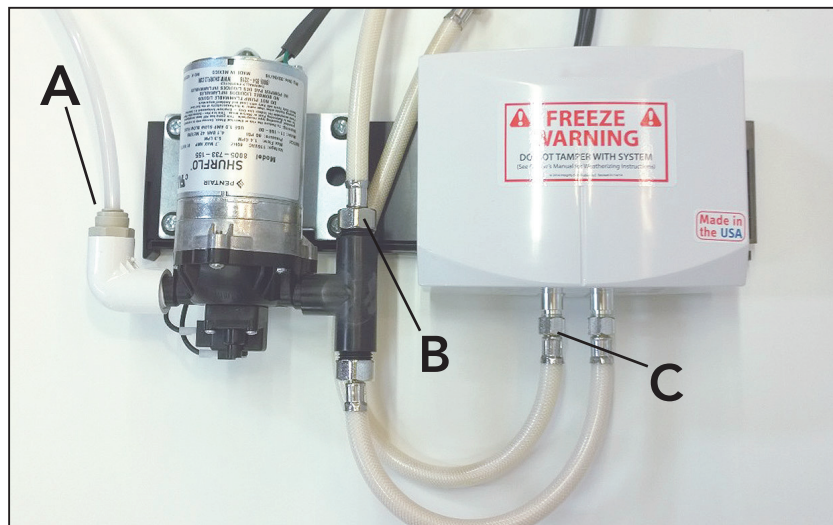



STEP 6



STEP 7

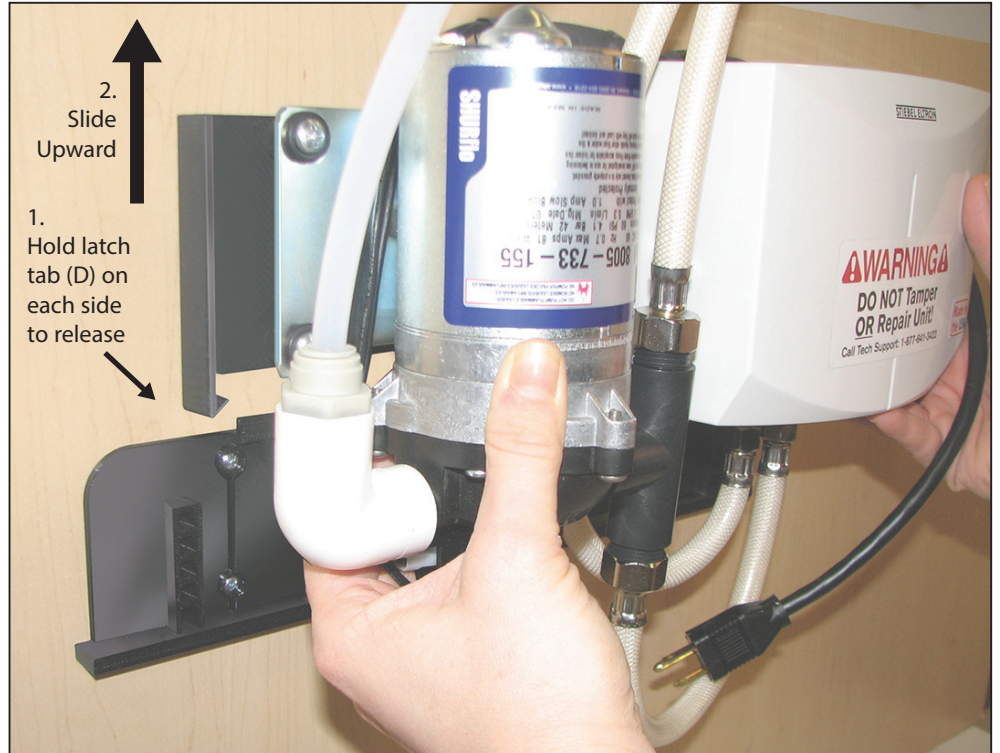

Gently move latch tab on each side of bracket outward and hold the latch tab. Lift up and out to remove the Hot Water System.

⚠ CAUTION ⚠

Follow All Packaging Directions from Document labeled "QH-104.pdf"

To eliminate damages make sure the Hot Water System is packaged as directed.

It is the financial responsibility of the shipper to assure safe delivery.